

Creating Forms

Forms allow information to be obtained from users of a web site. The ability for someone to purchase items over the internet or receive information from internet users has become a standard feature in many web sites. One way to do this is through the use of a FORM. Creating an interactive form is a two-part process. First you layout the form's objects (called fields) and then you link the objects to a Common Gateway Interface (CGI) script, which has to be done in consultation with an Internet Service Provider.

In this chapter you will create a form for the TravelWise Travel Agency.

Starting the Page

The form will use the template that was created in the last chapter.

- 1 Load DreamWeaver or close the current pages and select CREATE NEW in the START screen, or select NEW from the FILE menu.

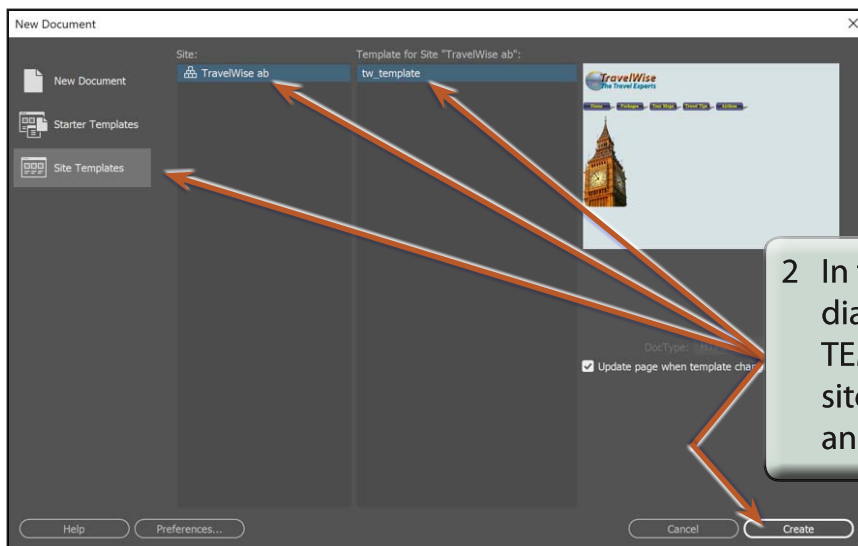

- 3 Check that the FILES panel is set to your TRAVELWISE site and the screen is set to DESIGN VIEW.
- 4 Save the page as:

orders.html

Inserting the Form Tag

When creating a form you must tell the program that a form will be used to gather information from the user. All the details within a form MUST be contained within an area called a FORM TAG, so whenever you start a form it is best to insert a FORM TAG.

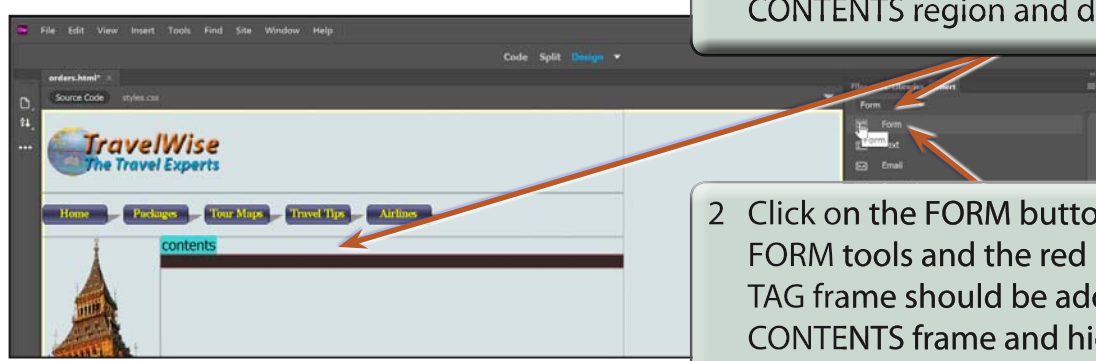

The screenshot shows the Adobe DreamWeaver interface with a website template titled "TravelWise The Travel Experts". The "contents" frame is highlighted in blue. The "INSERT" panel is open, and the "FORM" button is selected. A red dotted frame is visible around the "contents" frame, indicating the insertion of a form tag.

- 1 Open the INSERT panel, set its top box to the FORM tools then highlight the CONTENTS text in the CONTENTS region and delete it.
- 2 Click on the FORM button in the FORM tools and the red FORM TAG frame should be added to the CONTENTS frame and highlighted.

Entering the Form Introduction

Text needs to be provided to explain details about the form to users.

A Adding the Sub-Heading

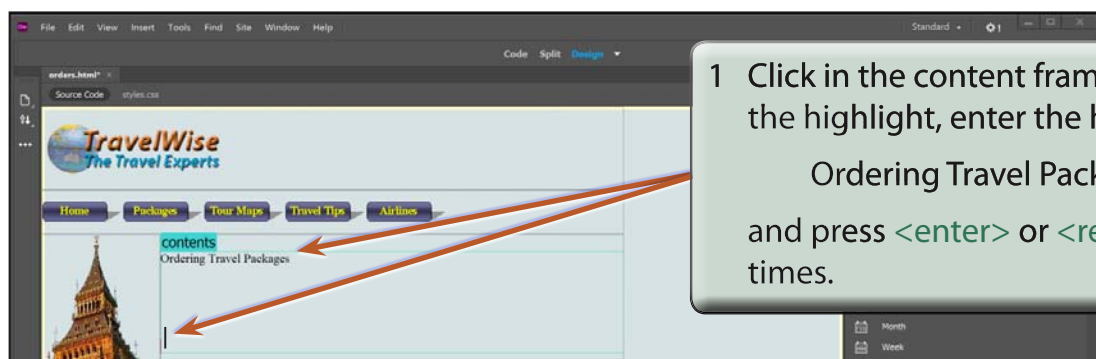

The screenshot shows the Adobe DreamWeaver interface with the "contents" frame highlighted. The text "Ordering Travel Packages" is entered into the frame. A red dotted frame is visible around the "contents" frame, indicating the insertion of a form tag.

- 1 Click in the content frame to remove the highlight, enter the heading:
Ordering Travel Packages
and press <enter> or <return> three times.

NOTE: As you create the form a red dotted frame will appear. This is the FORM tag and everything in the form should be within it.

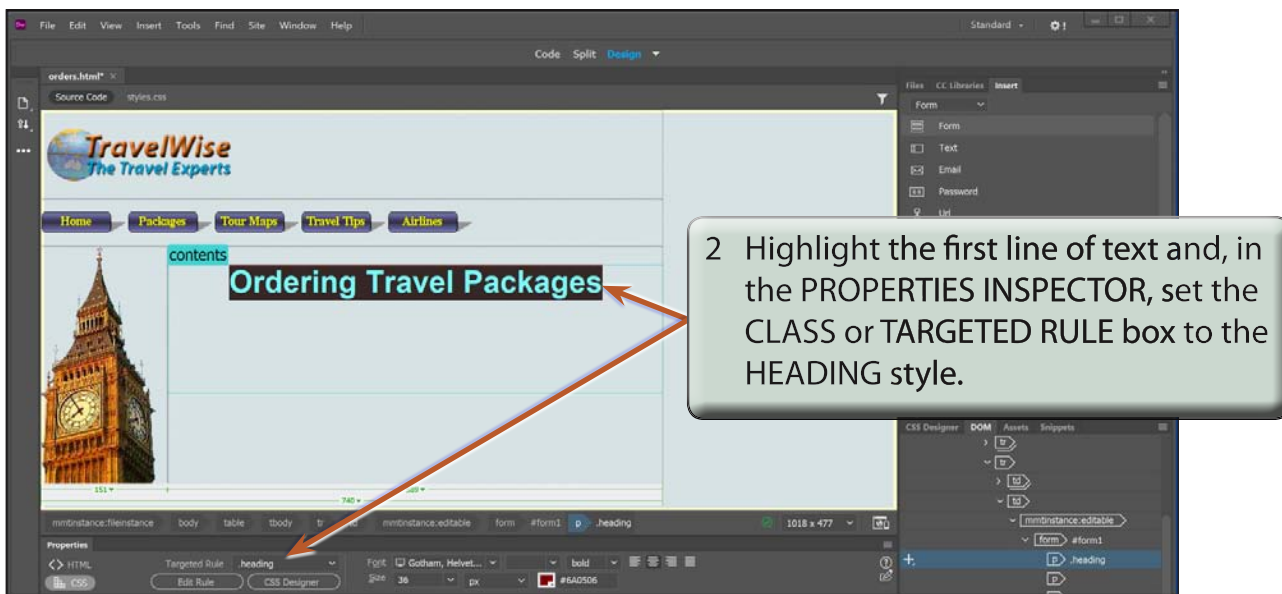

B Entering a Message

A message about the order form will be added under the heading in a table.

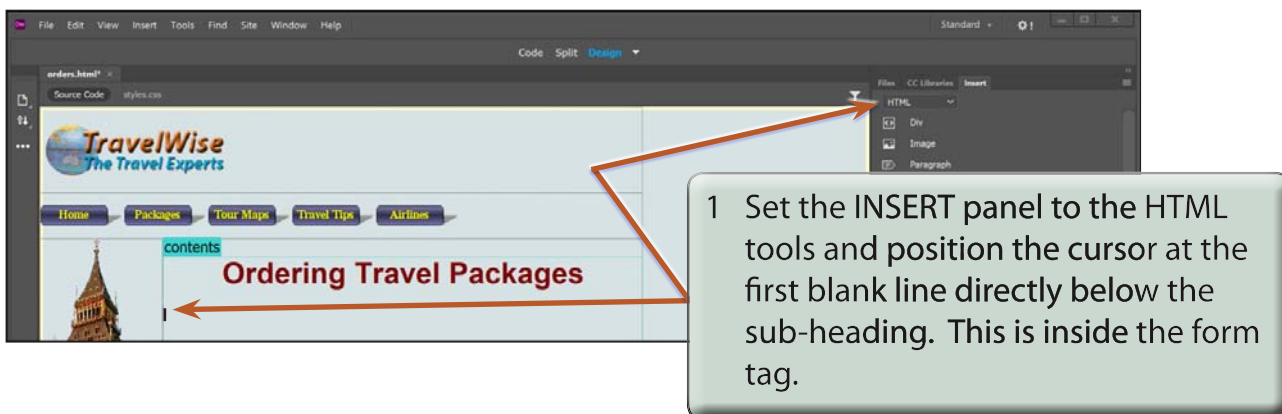

2 Click on the TABLE button in the HTML tools of the INSERT panel.

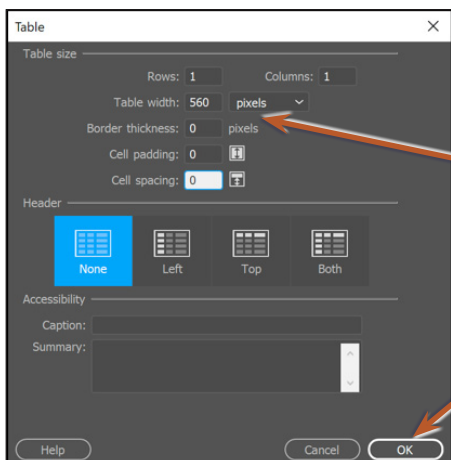

3 Set the table to have 1 ROW, 1 COLUMN, a WIDTH of 560 pixels, a BORDER THICKNESS of 0, a CELL PADDING of 0 and CELL SPACING of 0, then select OK to insert the single-celled table.

NOTE: The table is set to a fixed width of 560 pixels so that it can be aligned with other objects in the form.

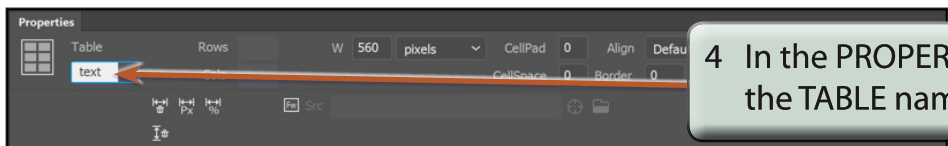

4 In the PROPERTIES INSPECTOR set the TABLE name box to TEXT.

5 Click in the table's cell and enter:

TravelWise provides quotes for travel packages online. Complete the following details and we will send prices to you within 24 hours of receipt of the form.

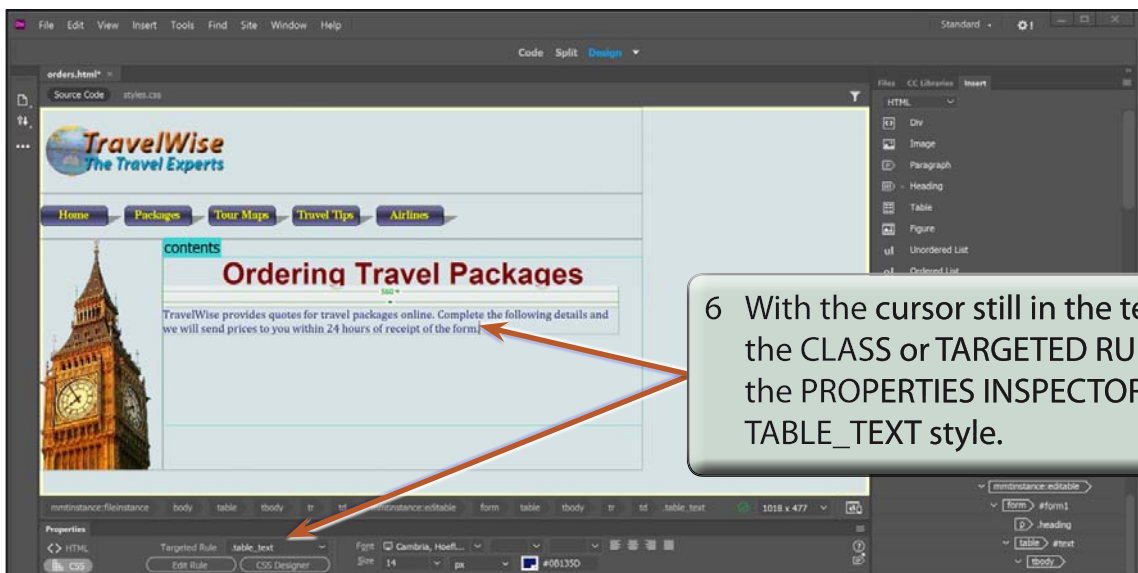

6 With the cursor still in the text, set the CLASS or TARGETED RULE box in the PROPERTIES INSPECTOR to the TABLE_TEXT style.