

Using Vector Shapes

FireWorks provides basic vectors shapes such as rectangle, ellipses and polygons. It also provides a range of auto vector shapes such as stars, spirals, rounded rectangles, etc. These shapes can be modified to create different shapes.

Starting the Document

- 1 Load Adobe FireWorks CS6 or close the current documents then select FIREWORKS DOCUMENT from the CREATE NEW section of the FIREWORKS WELCOME SCREEN.

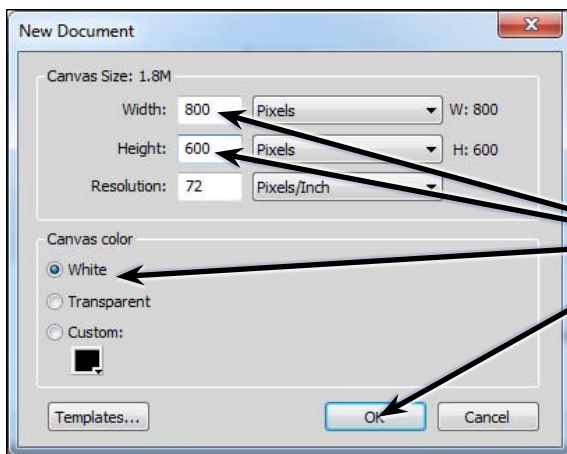

- 2 Set the WIDTH to 800 pixels, the HEIGHT to 600 pixels, the CANVAS COLOUR to WHITE and select OK.

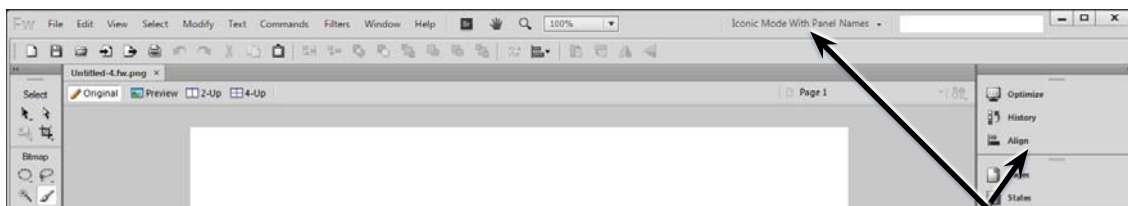

- 3 Use the MENU BAR to set the workspace to ICONIC MODE WITH PANEL NAMES so that the panel names are displayed in the PANEL GROUP.

Drawing an Auto Vector Shape

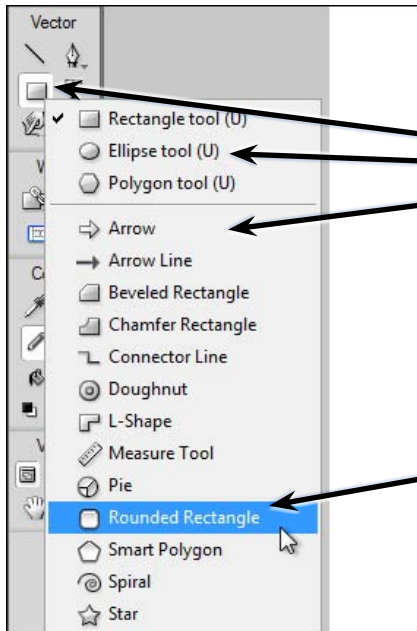

1 Click and hold on the SHAPES TOOL in the VECTOR section of the TOOLS panel. The basic shapes are listed at the top of the popup list and the auto shapes are in the lower section.

2 Select the ROUNDED RECTANGLE TOOL in the auto shapes section.

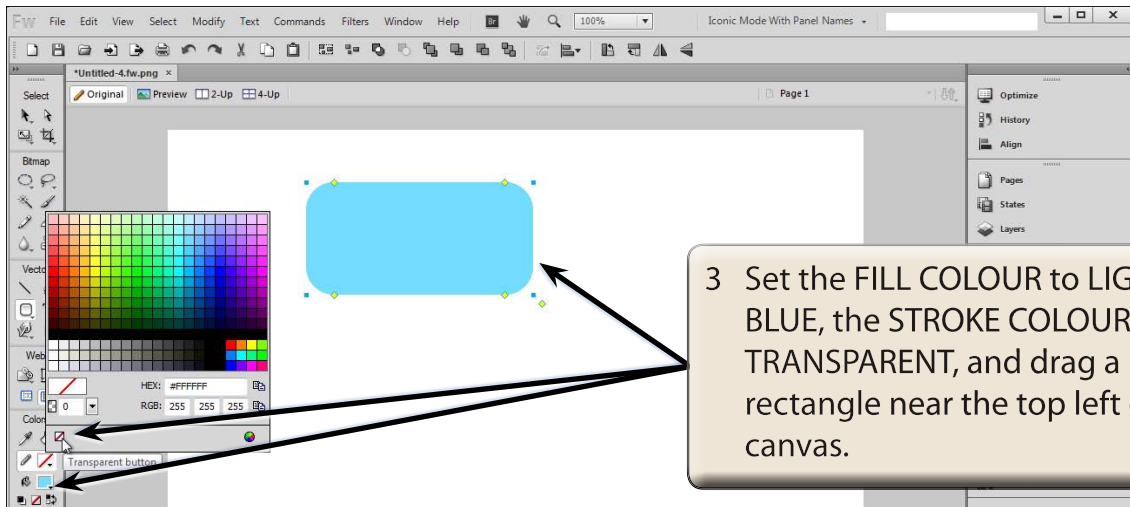

3 Set the FILL COLOUR to LIGHT BLUE, the STROKE COLOUR to TRANSPARENT, and drag a rounded rectangle near the top left of the canvas.

The Auto Shape Handles

Auto Shapes have the blue size handles that are present when you select Basic Shapes, but they also have a set of yellow diamond shaped handles which can be used to make adjustments to the Auto Shape.

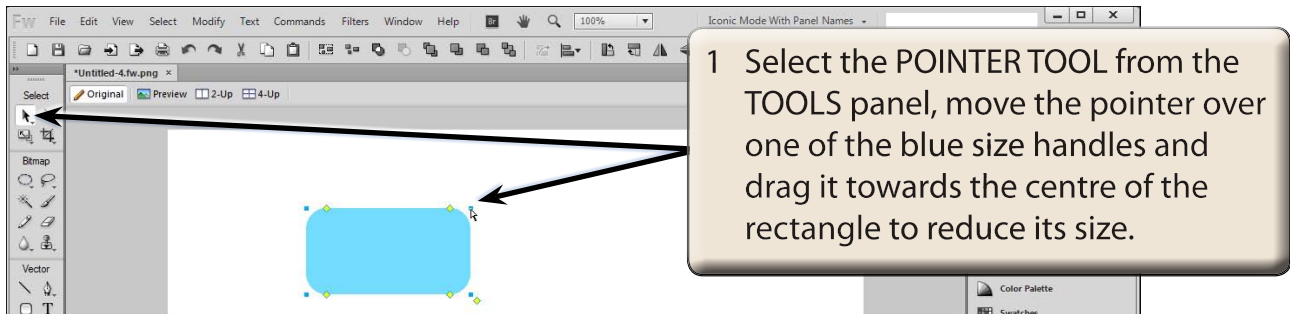

- NOTE:**
- i The blue size handles on Auto Shapes work in exactly the same way as you have used for Basic Shapes, such as resizing a rectangle.
 - ii If you hold down the **SHIFT** key as you drag a size handle, the proportions of the shape are maintained.

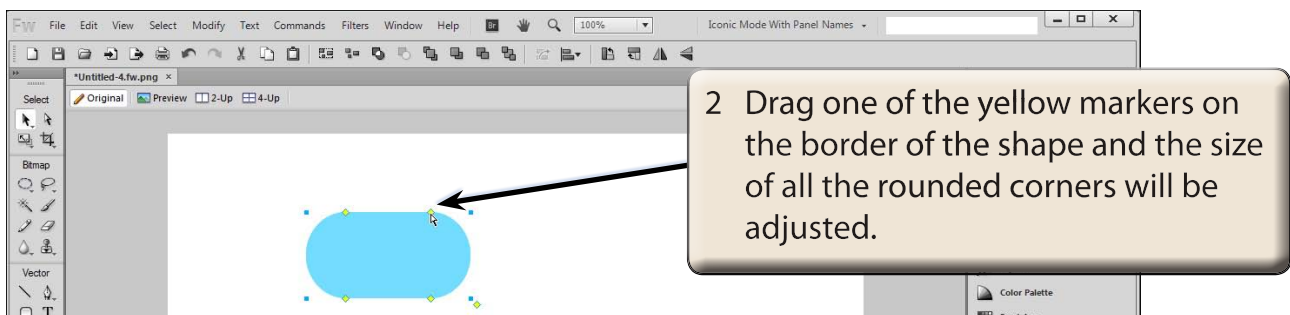

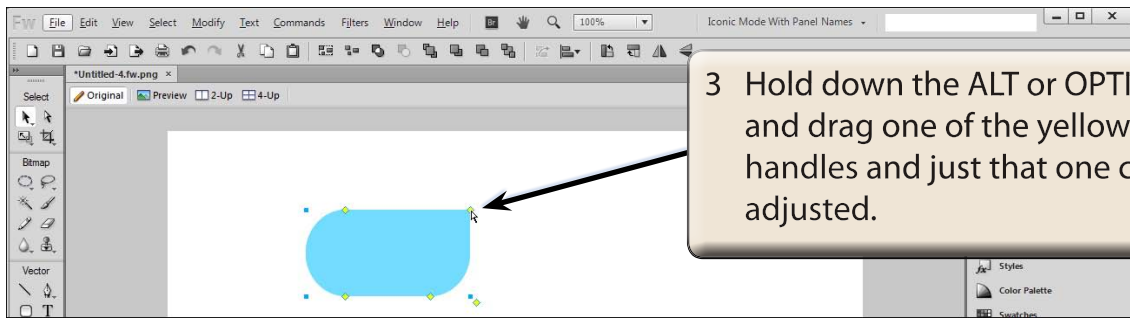

3 Hold down the ALT or OPTION key and drag one of the yellow border handles and just that one corner is adjusted.

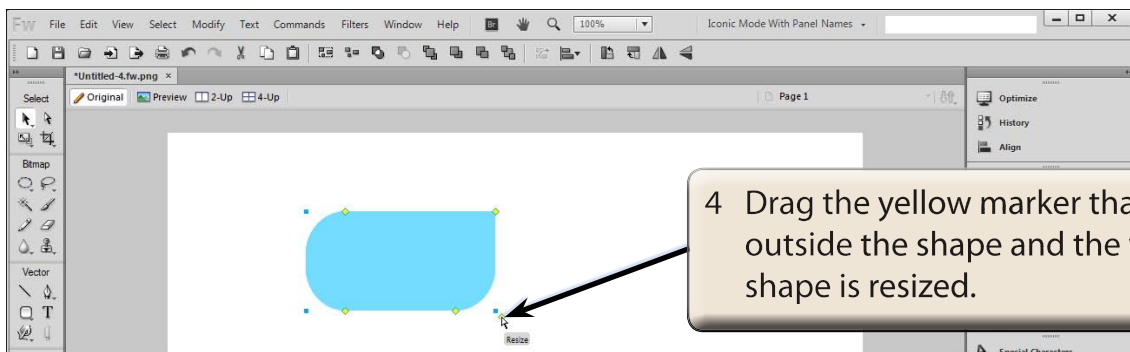

4 Drag the yellow marker that is outside the shape and the whole shape is resized.

Rotating Shapes

Shapes can be easily rotated or flipped horizontally or vertically.

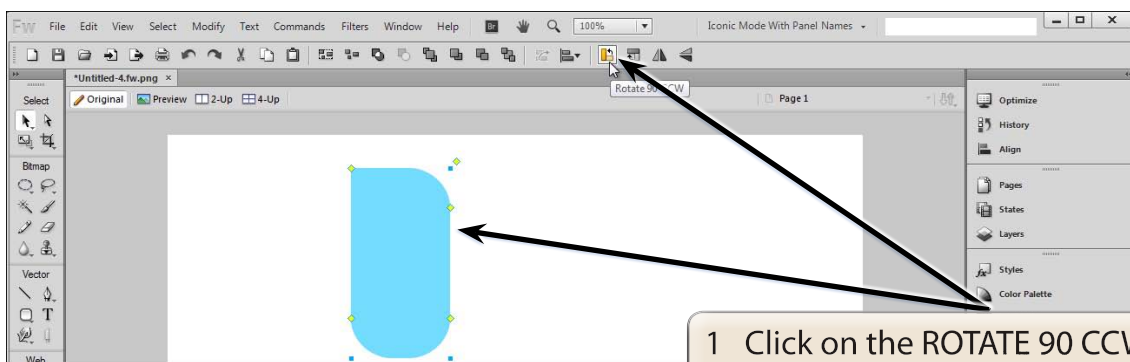

1 Click on the ROTATE 90 CCW button in the COMMON Toolbar to rotate the shape 90° to the left (counter clockwise).