

Creating Accurate Designs

Adobe Illustrator provides tools to create highly accurate designs, some of which in the past have required a dedicated and expensive Computer Aided Design program. To illustrate how to produce an accurate design, the following Conference Room design will be created.

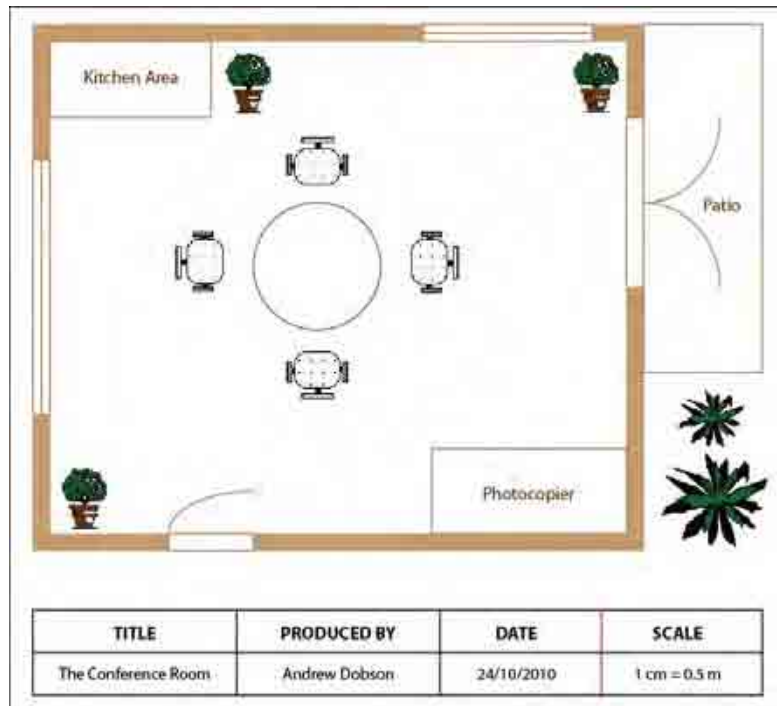

Starting a New Document

- 1 Load Adobe Illustrator CS4 or close the current file and, in the CREATE NEW section of the ILLUSTRATOR WELCOME SCREEN, start a new PRINT DOCUMENT.

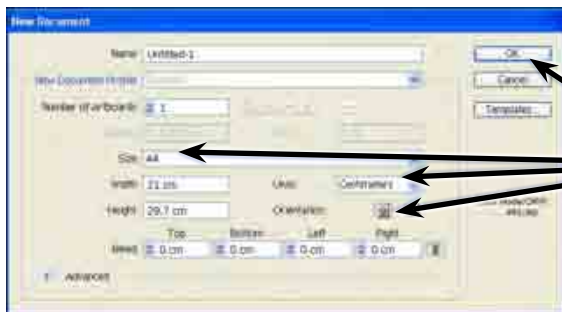

- 2 Set the SIZE to A4 (or the paper size your printer uses), the UNITS to CENTIMETRES, the ORIENTATION to PORTRAIT and select OK.

- 3 Use the VIEW menu to turn on SHOW RULERS, SHOW GRID and SNAP TO GRID.

Setting the Scale

You should select an appropriate scale for a design such as this. A scale might be 1 cm = 1 m or 1 cm = 1 km, etc. So that the conference room will fit neatly on the page we will use a scale of 1 cm = 0.5 m. To do this a slightly more accurate grid will be used.

- 1 Display the EDIT menu on the Windows system or the ILLUSTRATOR menu on the Macintosh system, highlight PREFERENCES and select GUIDES & GRID.

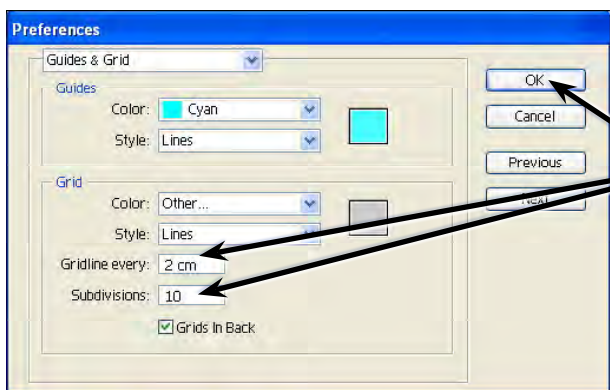

2 Leave the GRIDLINES EVERY as 2 cm, enter 10 in the SUBDIVISIONS box and select OK.

Entering the Walls of the Room

We will use thick shaded lines to produce the outline of the room.

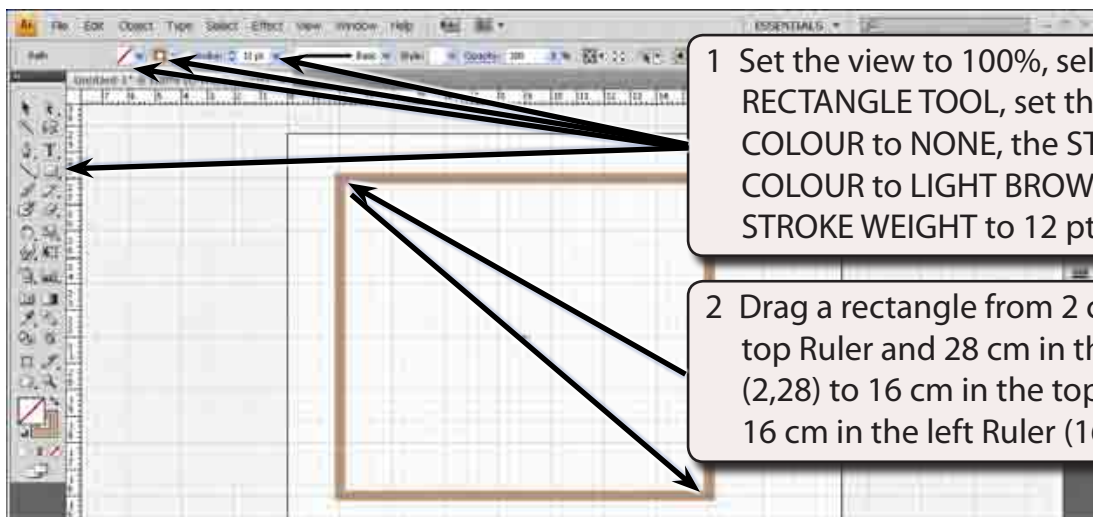

1 Set the view to 100%, select the RECTANGLE TOOL, set the FILL COLOUR to NONE, the STROKE COLOUR to LIGHT BROWN and the STROKE WEIGHT to 12 pt.

2 Drag a rectangle from 2 cm in the top Ruler and 28 cm in the left Ruler (2,28) to 16 cm in the top Ruler and 16 cm in the left Ruler (16,16).

NOTE: This has drawn a rectangle that represents 7 m across (14 cm on the screen) and 6 m down (12 cm on the screen).

Adding the Windows

Windows are usually represented by a thin rectangle with a line through it.

- 1 Increase the zoom to 150% using CTRL+ or COMMAND+.

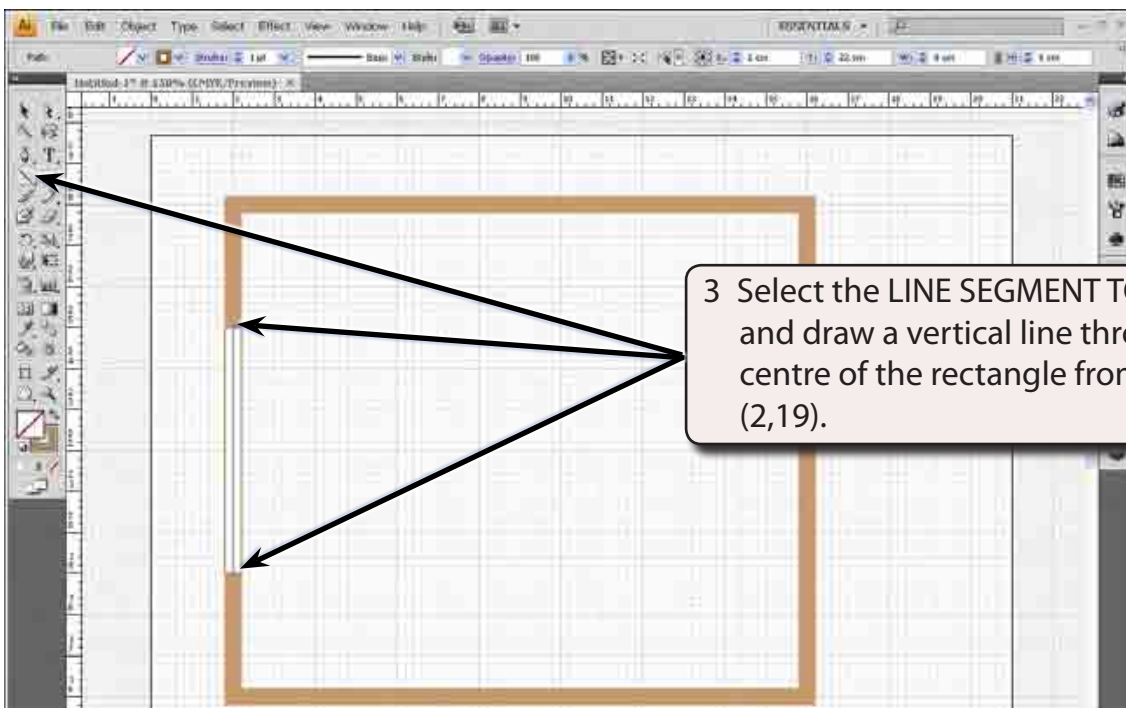
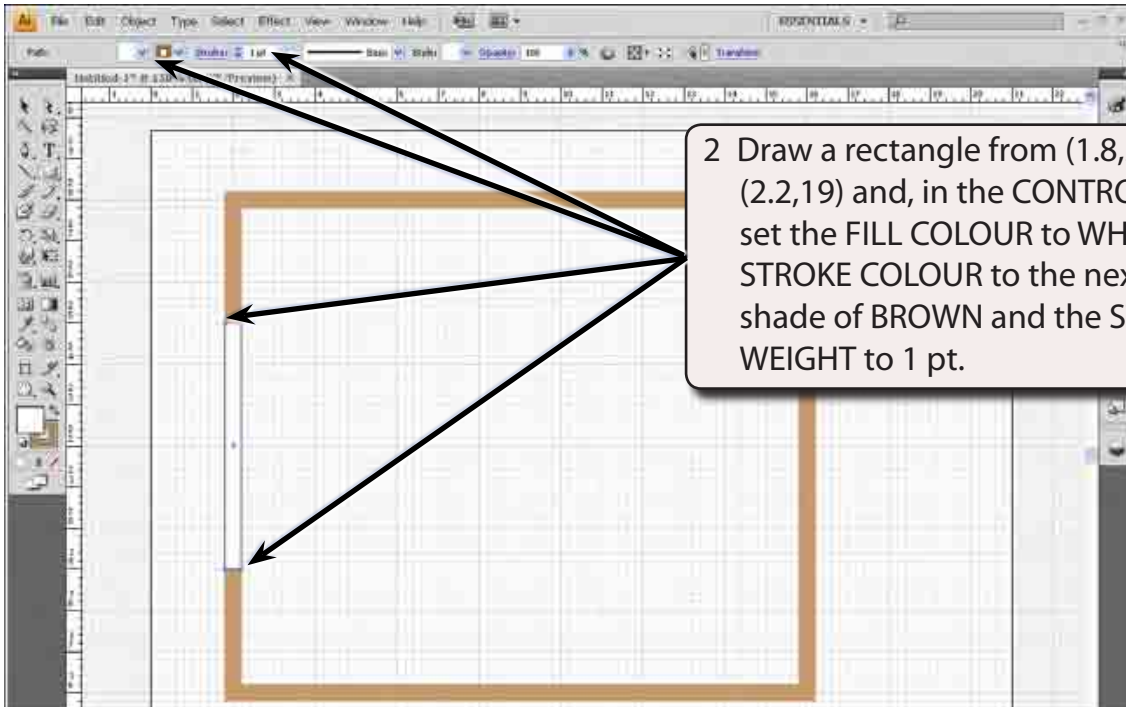

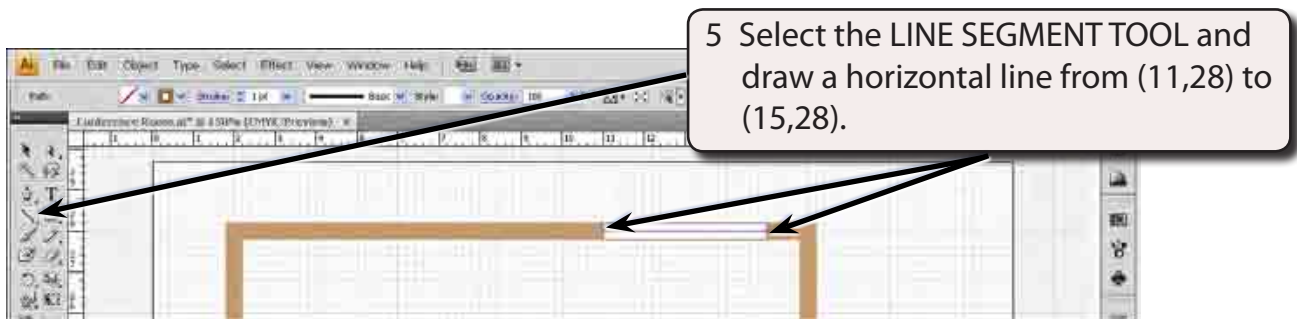
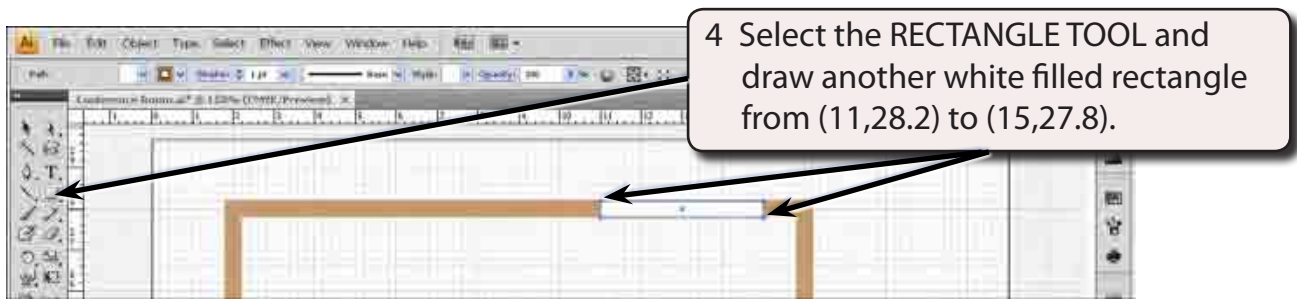

- 6 Save the document in your STORAGE folder as:
Conference Room

Adding the Doors

We will represent the doors with a rectangle and an arc attached to it. There are two sets of doors required, one set of double doors and one single door.

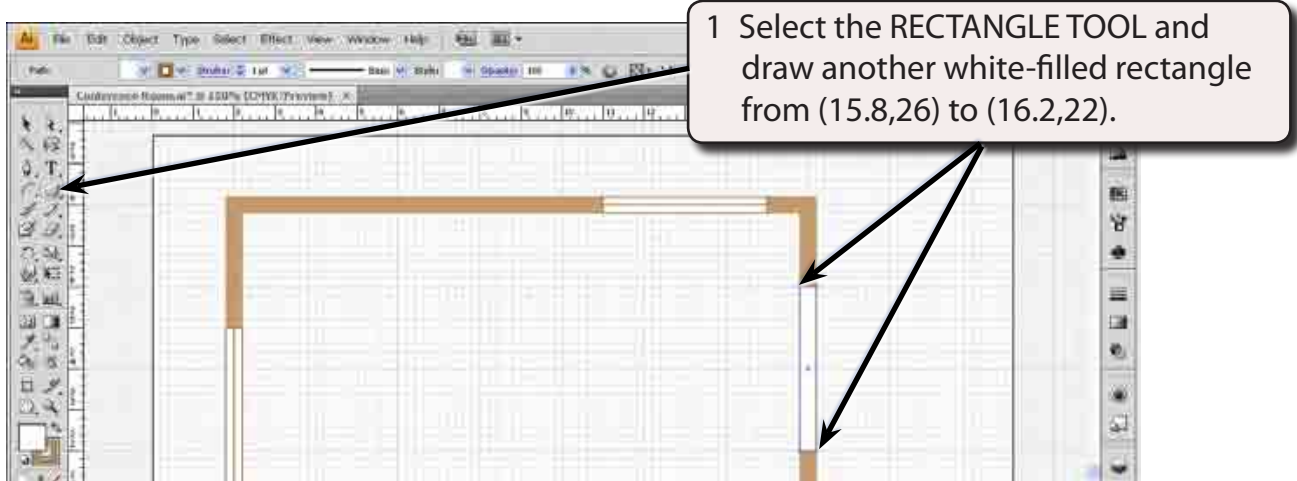

- 2 Select DESELECT from the SELECT menu (or press SHIFT+CTRL+A or SHIFT+COMMAND+A) to deselect the rectangle.

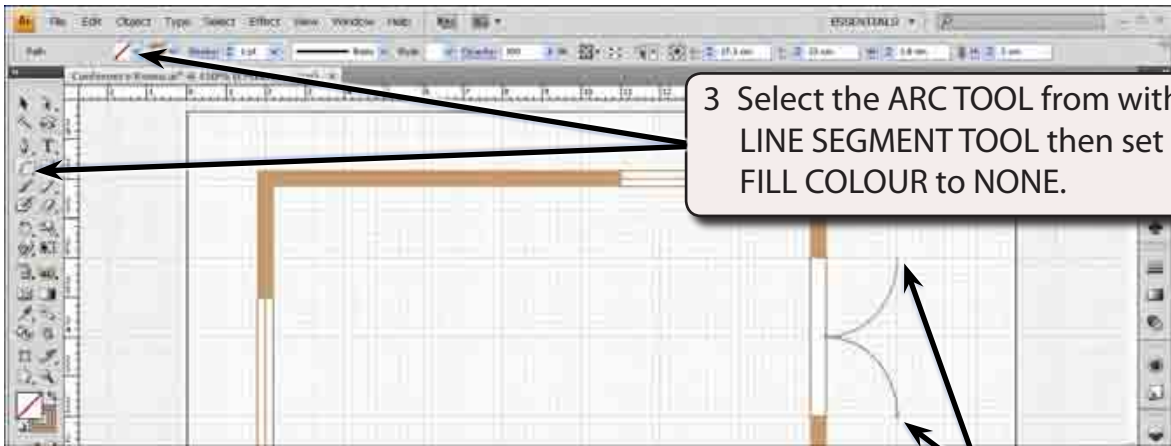

3 Select the ARC TOOL from within the LINE SEGMENT TOOL then set the FILL COLOUR to NONE.

4 Draw 2 brown arcs from (18,26) to (16.2,24) and (18,22) to (16.2,24).

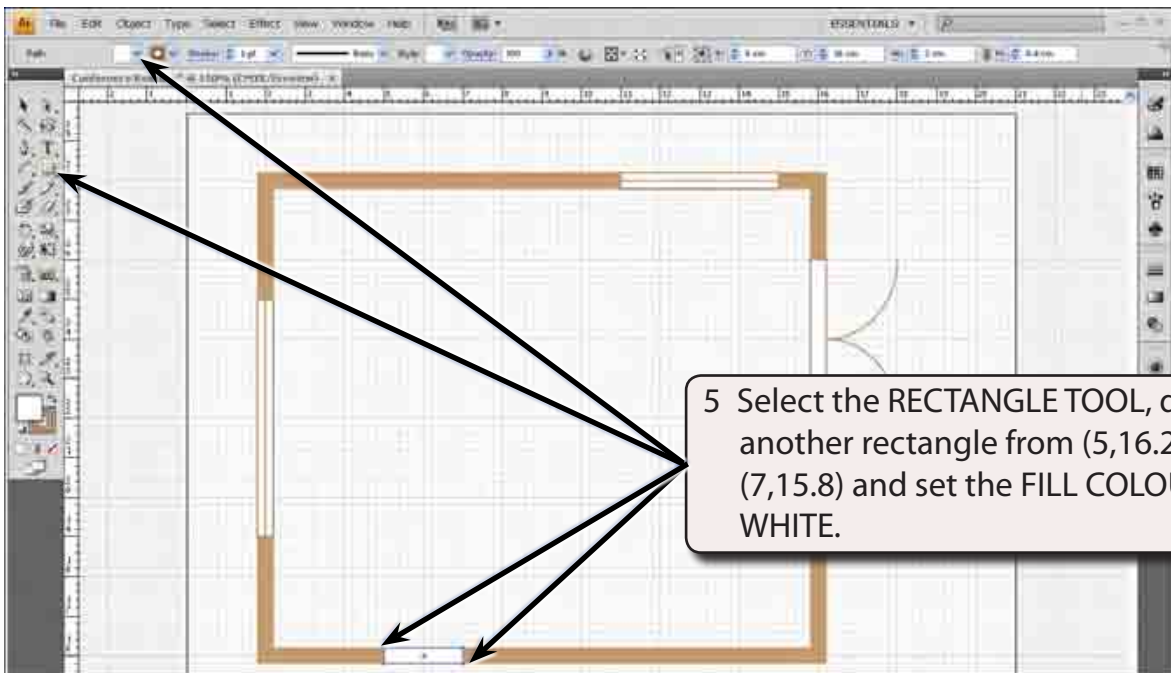

5 Select the RECTANGLE TOOL, draw another rectangle from (5,16.2) to (7,15.8) and set the FILL COLOUR to WHITE.

6 Press SHIFT+CTRL+A or SHIFT+COMMAND+A to deselect the rectangle.

NOTE: Co-ordinates are listed with the top Ruler value first then the left Ruler value. So, (5,16.2) means 5 cm in the top Ruler and 16.2 cm in the left Ruler.